

**BALDWIN HILLS CONSERVANCY
NOTICE OF PUBLIC MEETING**

The meeting of the Baldwin Hills Conservancy (BHC) will be held
Friday, April 28, 2017, 10:00 a.m. - 12:00 p.m.

Kenneth Hahn State Recreation Area

**4100 South La Cienega Blvd
Los Angeles, CA 90056
(323) 298-3660**

Teleconference Location

Natural Resources Agency
1416 Ninth Street, 13th Floor, Room 1305
Sacramento, California 95814

10:00 a.m. - CALL TO ORDER - Dr. Yolanda Gorman, Chair

MEETING AGENDA

PUBLIC COMMENTS ON AGENDA OR NON-AGENDA ITEMS SHOULD BE SUBMITTED BEFORE ROLL CALL

Public Comment and Time Limits: If you wish to speak on an agenda item, please complete a speaking card available near the door to the meeting room. Individuals wishing to comment will be allowed up to three minutes to speak. Speaking times may be reduced depending upon the number of speakers.

1. Roll Call - Avril LaBelle, Executive Secretary
2. Approval of Minutes (February and March) - Dr. Yolanda Gorman, Chair
3. Consideration of a Resolution Authorizing an Amendment to the Project Scope, Timeline, and Budget for Proposition 84 Agreement #BHC15002, with Culver City for the Park to Playa, Ballona Creek Connection Project
4. Executive Officer Report - Project Status Update, Fiscal Update, Legislative Update - BHC Staff Representatives
5. Public Comments - Dr. Yolanda Gorman, Chair
6. Board Member Announcements or Proposed Agenda Items for Future Meetings

****Next meeting is tentatively scheduled for June 16, 2017***

ADJOURNMENT

In accordance with the Americans with Disabilities Act of 1990, if you require a disability related modification or accommodations to attend or participate in this meeting, including auxiliary aids or services, please call the Conservancy at (323) 290-5270 at least five days prior to the meeting. For more information about the Conservancy, you may visit our website at www.bhc.ca.gov

Be it known pursuant to Government Code Sections **54956.8**, **54956.9**, the Conservancy may hold a closed session to discuss and take possible action regarding instructions on real estate negotiations, on personnel matters and/or to receive advice of counsel on pending or potential litigation. Confidential memoranda related to these issues may be considered during such closed session discussions.

PUBLIC MEETING MINUTES
BALDWIN HILLS CONSERVANCY
Friday, February 3, 2017

10:00 a.m. Call to Order - A public meeting of the Baldwin Hills Conservancy (BHC) was assembled at 10:00 a.m. on Friday, February 3, 2017, at the Kenneth Hahn State Recreation Area Community Center located at 4100 South La Cienega Boulevard, Los Angeles, CA 90056.

I. - Roll Call

Members Present: Julie Alvis, Sara Amir, Jacquelyn Dupont-Walker, Dr. Yolanda Gorman, Lacey Johnson, Robert Jones, Eraina Ortega, Patricia O'Toole, Kevin Regan, Craig Sap, Keshia Sexton (*arrived after Item II*) Anna Straabe, Marina Voskanian.

Staff Present: David McNeill, Executive Officer; David Edsall, Deputy Attorney General, DOJ; Gail Krippner, Grant Program Manager; Noa Rishe Khalili, Park and Recreation Specialist; Daniel Sciolini, Staff Services Analyst; Avril LaBelle, Executive Secretary.

Deputy Attorney General David Edsall conducted the swearing in of new board member Kevin Regan, Deputy Director, Department of Parks and Recreation, County of Los Angeles.

II. - Approval of Minutes (December) – Dr. Yolanda Gorman, Chair

The Chair called for a motion to approve the minutes. Member Jones so moved, Member Dupont-Walker seconded the motion, and a roll call vote was taken – **8 aye, 0 nay, 0 abstain, Minutes Approved.**

III. - Public Comments – Dr. Yolanda Gorman, Chair

Public comment was invited. No comment cards were received.

I. - Presentation on the Baldwin Hills Biota Update Final Draft – Dr. Travis Longcore, University of Southern California, Spatial Sciences Institute

Ms. Rishe Khalili - The Biota Update is a comprehensive study of the reptiles, vegetation, amphibians, bats, and Mesocarnivores of the Baldwin Hills. This comprehensive study resulted in a baseline for the Biota in the Baldwin Hills area.

Dr. Longcore gave an informative PowerPoint presentation covering: Historic Wetlands, Soils, Climate of the Baldwin Hills, Vegetation Maps, and What is Flowering; Amphibians, frogs, toads, and salamanders; Mammals, Bats, and Reptiles; Birds and Invertebrates of the Baldwin Hills; and the iNaturalist.org Website and Application. (Information gathered is presented in a public website that will be published. Vegetation maps were created from satellite imagery and field observation; researchers did not access public lands to make field observations.) (Please visit the Community Standards District website for information on biota in the Inglewood Oilfield.)

Reptiles and Amphibians: Collaborators at the Natural History Museum spent thousands of hours searching for reptiles and amphibians, and discovered species native to California including: Pacific Tree Frog, Western Toad, Black Bellied Salamander, Slender Salamander, Western Skink, Western Fence Lizard, Side Blotched Lizard, Coachwhip, Gopher Snake, California Kingsnake, Ring-necked Snake. Never previously documented before, the Western Skink may represent a population that has managed to survive in the Baldwin Hills for hundreds of thousands of years. Non-native species such as American Bullfrog and several turtle species were also found.

Snakes: There are zero credible records of rattlesnakes in the Baldwin Hills. There are Kingsnakes and Pacific Gopher Snakes. Gopher Snakes can rattle. There are no poisonous, venomous snakes in the Baldwin Hills. There are rattlesnakes in the Ballona Wetlands, but zero in the Baldwin Hills.

Mesocarnivores: Mesocarnivores are mid-sized carnivores. There are no large carnivores in the Baldwin Hills. There are documented Mesocarnivores such as: opossum, racoon, Stripped Skunk, and Grey Fox. (Over 20,000 photographs were classified into species.) There are coyotes now throughout. There is a change throughout the country as coyotes are adapting to cities. Coyotes are no longer living in the hills and coming down to the cities looking for food. The city is now their habitat, and they are coexisting. The greatest number of coyotes were noted at Culver City Park. Humans continue to put food out which attracts coyotes and other animals.

Bat Facts: Echo location devices confirmed four species of bats: the Yuma Myotis, Mexican Free-Tailed Bat, Western Red Bat, and the Hoary Bat. Some bats hate lights, and others like lights because they draw insects. The Culver City Ball Fields have a high concentration of bats that are foraging the insects attracted to the lights there. There are also bats attracted to the water at the Ballona Creek, eating thousands of insects per night. Bats might also be seen along the constructed ponds in Kenneth Hahn Park.

Birds: The bird data was not updated as there are many Birders in the Baldwin Hills. Most active Birders record their observations on a sight called **eBird** - <http://ebird.org/ebird/hotspot/L688203?m=&yr=last10&changeDate=Set> There is a credible sighting of a California Gnatcatcher (Threatened species, Very Rare.) (See attached PowerPoint Presentation Slide – “The Coastal Scrub Obligates - Absent or Very Rare”)

iNaturalist.org Website & Application: <http://www.inaturalist.org/guides/3102?view=card> iNaturalist is where people can record their observations of nature in the Baldwin Hills. For example, some of the snake observations came with pictures which were geotagged and dated. A Species Guide is being developed so that people visiting the Baldwin Hills can identify species that were here historically and what is there today. The Natural History Museum conducted a Bio-Blitz here in the Baldwin Hills where experts identified species. That information is in the Baldwin Hills Biota Project on iNaturalist and will continue to grow as people participate. (See attached Memorandum dated 2/3/2017, – Item 4: Presentation on the Baldwin Hills Biota Update Final Report – Dr. Travis Longcore, University of Southern California, Spatial Sciences Institute; and PowerPoint Presentation Slides - Urban Biodiversity Assessment: Baldwin Hills Biota Update.)

II. - Discussion and Possible Action on the Baldwin Hills Conservancy 2017 Strategic Plan Update – David McNeill, Executive Officer

Mr. McNeill – The Strategic Plan revolves around the Baldwin Hills Park Masterplan which gives us our guideline and statute that we follow. Updates to the Strategic Plan occur every

two - three years. An overview of the update is outlined in the attachments. *(For details please see attached Memorandum dated 2/3/2017, – Item 5: Discussion and Possible Action on the Baldwin Hills Conservancy 2017 Strategic Plan Update; and Attachment #1 - Baldwin Hills Conservancy 2017 Updated Strategic Plan.)* (Note correction: Attachment #1, Page 3. “January 1, 2026.”

Board Members discussed, and the Chair called for a motion to vote. Member Jones so moved, Member Johnson seconded the motion, and a roll call vote was taken – **9 aye, 0 nay, 0 abstain, Resolution 16-08 Approved.**

III. - Executive Officer Report: Project Status Update, Fiscal Update - BHC Staff Representatives

Project Status Update

Proposition 40 - Gail Krippner

Stoneview Nature Center – The park is approximately 95% complete. The contractor is completing the final punch list. Final inspections including the Public Health Department and the Fire Department are taking place. Once those are closed the temporary certificate of occupancy will be received and the park can be officially open to the public. The tentative date for park grand opening is 4/8/2017.

Proposition 84 – Noa Rishe Khalili

University Southern CA (USC) – The Final Biota Report - Research was completed August 2016. The final report and website will be released the end of this month.

Hetzler Road Pedestrian Path – Culver City is currently working on this project at the Baldwin Hills Scenic Overlook. Construction is going very well. The rain has pushed the completion date to the end of April 2017, and the grand opening date to June 16th.

Park to Playa Trail, Ballona Creek Connection – The City of Culver City is moving toward creating the Park to Playa Ballona Creek Connection; which is the section that will go through Culver City Park. They will be going out to bid within a few weeks.

Loyola Marymount (LMU) – LMU is in their fourth season of the Parklands Users Survey. Project completion is set for fall 2017

Baldwin Hills Parklands Conservation (BHRCA) – L.A. Audubon is working on this project. They are working on two parts to this project - the Summer and Spring Camps, and the Certificate Program with West L.A. College. The first semester of the college certificate program has begun. Project completion is set for August 2019.

Proposition 1 – Daniel Sciolini

Culver City Waste Transfer Station – Construction of the Diversion System is set to begin in summer of 2017. The contract for Phase II – design of the Rain Garden was awarded in January. Completion is expected in spring 2018.

MRCA Milton Green Street – A draft flyer and FAQ sheet for the traffic control plan are being finalized, and set for distribution during the month of April. A construction bid went out in January, bids are due back mid-February. The MRCA will be awarding the contract sometime during March/April. Construction is scheduled to begin during May 2017. Project completion is expected summer 2018.

Proposition I Workshops – The most recent workshop took place at the Yvonne Burke Senior and Community Center, on January 19, 2017. The workshop centered on educating on partnerships.

Executive Officer Report/Fiscal Update – David McNeill

Project Status Report – *(See attached Memorandum dated 2/3/2017, “Item 6: Executive Officer Report;” Attachment #1 – Baldwin Hills Conservancy (BHC) Project Status Report.)*

Fiscal Update – (See Attachment #2 – Baldwin Hills 2016/17 Summary Sheet by Fund; and Attachment #3 – Bond Cash Funds as of 11/30/17.)

IV. Board Member Announcements or Proposed Agenda Items for Future Meetings

Mr. McNeill - On March 17th, the BHC will be conducting a tour of project based locations for members of the public and board members. Sign up is required.

Vice Chair Dupont-Walker reminded everyone it is Black History Month.

Member Sap – The Ron Schafer bridge at Leo Carrillo State Park was completed just prior to the rainy season. Environmental Impact Statement and Environmental Impact Report for the bridge dam ecosystem will be in the 60-day comment period.

Member Jones – Expressed appreciation to Dr. Travis Longcore for a great presentation and for the hard work put forth to accomplish the BHC Biota Study.

The BHC also extends its gratitude to Dr. Longcore.

The BHC congratulates and welcomes new Board Member Kevin Regan.

The next board meeting is tentatively scheduled for **March 17, 2017.*

ADJOURNMENT

There being no more business brought before the board, the meeting was adjourned at **11:23 a.m.**

Approved:

Dr. Yolanda Gorman, Chair

Date:

BALDWIN HILLS CONSERVANCY

5120 West Goldleaf Circle, Suite 290

Los Angeles, CA 90056

Phone: (323) 290-5270

PUBLIC MEETING MINUTES
BALDWIN HILLS CONSERVANCY
Friday, March 17, 2017

9:00 a.m. Call to Order - A public meeting of the Baldwin Hills Conservancy (BHC) was assembled at 9:00 a.m. on Friday, March 17, 2017, at the Kenneth Hahn State Recreation Area Community Center located at 4100 South La Cienega Boulevard, Los Angeles, CA 90056.

I. - Roll Call

Members Present: Sara Amir, Dr. Yolanda Gorman, Lacey Johnson, Robert Jones, Jason Marshall, Eraina Ortega, Starlett Quarles, Kevin Regan, Craig Sap, Anna Straabe, Marina Voskanian.

Staff Present: David McNeill, Executive Officer; David Edsall, Deputy Attorney General, DOJ; Gail Krippner, Grant Program Manager; Noa Rishe Khalili, Park and Recreation Specialist; Daniel Sciolini, Staff Services Analyst; Avril LaBelle, Executive Secretary.

II. - Approval of Minutes (February) – Dr. Yolanda Gorman, Chair

The vote on minutes was deferred to the next board meeting.

III. - Presentation on Baldwin Hills Parklands User Survey Study – Loyola Marymount University's Center for Urban Resilience – Dr. Eric Strauss

Dr. Strauss and Dr. Romolini gave an informative presentation covering the Semiannual Report for Season 3 of the Park User Study of the Baldwin Hills. *(See attached memorandum dated March 17, 2017, "Item 3: Presentation on Baldwin Hills Parklands User Survey Study – Loyola Marymount University's Center for Urban Resilience – Dr. Eric Strauss," and Attachment #1 "The Value of Urban Parklands: A Park User Study of the Baldwin Hills Semiannual Report Season 3.")*

IV. -Executive Officer Report: Project Status Update, Fiscal Update, Legislative Update - BHC Staff Representatives

Project Status Update

Proposition 40 - Gail Krippner

Stoneview Nature Center (LA County Parks) – The certificate of occupancy has been received. The Grand Opening will take place Saturday, April 8, 2017, from 10:00 a.m.-2:00 p.m.

Proposition 84 – Noa Rishe Khalili -

Baldwin Hills Biota Study (USC) – The Final Biota Report has been completed. We are anticipating the report release and launch of the website.

Hetzler Road Pedestrian Path (Culver City) – This project will take pedestrians off the street and onto the walkway. The project is on schedule.

Loyola Marymount (LMU) – LMU is in their fourth season of the Users Survey.

Park to Playa Trail, Ballona Creek Connection (Culver City)– This is a trail for pedestrians and bicycles to have access from the Overlook down to Duquesne and out to the creek. There may be some delays in getting the bid advertising out, and we may have to discuss a possible project timeline extension.

Baldwin Hills Parklands Conservation (BHRCA) – This is the first semester of the certificate program with West L.A. College. There are approximately 15 students learning about park ecology and park conservation. On April 10, 2017, the Spring Conservation Camp will begin.

Proposition 1 – Daniel Sciolini

Culver City Waste Transfer Station (Culver City) – Construction of the Diversion System is set to begin in summer of 2017. Completion is on track for spring 2018.

MRCA Milton Green Street (MRCA)– Bids were received; March Construction authorized; Construction is scheduled to begin during May 2017. Project completion is expected summer 2018.

Program Delivery: Networking/Outreach – Participated in interagency coordination meeting regarding Chapter 6. Attending workshops, board meetings, and stakeholder events such as – Integrated Regional Water Management Plan; One Water Workshop; Green Streets Committee; Coastal Conservancy; Home Owner Association Meetings; Attending Alliance Meetings; Ca Fish and Wildlife; and Wildlife Conservation Board.

Executive Officer Report/Fiscal Update/Legislative Update – David McNeill -

Project Status Report – (See attached memorandum dated March 17, 2017, “Item 4: Executive Officer Report,” and Attachment #1 – “Baldwin Hills Conservancy (BHC) Local Assistance/Capital Outlay Projects Status Report.”) -

Fiscal Update – (See Attachment #2 – “BHC Summary Expenditure Sheet by Fund,” and Attachment #3 – “BHC Proposition 40 and Proposition 84 Bond Cash Funds.”) -

Legislative Update – (See Attachment #4 – “Bond Comparison – AB18 (Garcia) and SB5 (de Leon).”) -

V. Public Comments – Dr. Yolanda Gorman, Chair

Public comment was invited. No comment cards were received.

VI. Board Member Announcements or Proposed Agenda Items for Future Meetings

The Baldwin Hills Conservancy will be participating in Earth Day events in Inglewood, Exposition Park, Sony Pictures Entertainment Los Angeles State Historic Park from 4/15 through 4/22/2017.

The next board meeting is tentatively scheduled for **April 28, 2017.*

ADJOURNMENT

There being no more business brought before the board, the meeting was adjourned at **10:07 a.m.**

Approved:

Dr. Yolanda Gorman, Chair

Date:

BALDWIN HILLS CONSERVANCY

5120 West Goldleaf Circle, Suite 290
Los Angeles, CA 90056
(323) 290-5270 Phone
www.bhc.ca.gov

Memorandum

To: Governing Board

From: Noa Rishe Khalili, Park & Recreation Specialist

Date: April 28, 2017

Re: Item 3: Consideration of a Resolution Authorizing an Amendment to the Project Scope, Timeline and Budget for Proposition 84 Agreement #BHC15002 with Culver City for the Park to Playa, Ballona Creek Connection Project

Recommendation: Staff recommends approving Resolution 16-09, authorizing the Executive Officer to amend the project scope, timeline, and budget for Proposition 84 Agreement #BHC15002 with Culver City for the Park to Playa, Ballona Creek Connection Project.

Background: The performance period for the project grant agreement ends on June 30, 2017. An amendment to the project extending the performance period to June 30, 2018, is necessary to begin construction and complete the project. Changes to the project scope and budget may be necessary to accommodate the construction bids that will be presented in May 2017. Project staff anticipate the project cost could increase up to 20%, based upon design changes and an industry wide increase in construction costs (See *Attachment 1, Budget*). Authorizing the Executive Officer to amend the grant agreement timeline, scope and budget up to \$80,000 would allow the City to award the contract quickly, negotiate with the Conservancy and begin construction in July 2017. Culver City will increase their matching funds contribution up to \$59,421.

The Ballona Creek Connection Project will construct Segment 7 of the Park to Playa Trail through Culver City Park. This segment will 1) improve the existing trail, and remove barriers along the upper ball fields within Culver City Park; 2) create ADA accessible pedestrian passageways consistent with Park to Playa; 3) connect and improve the existing Interpretive Boardwalk Trail; 4) incorporate a bicycle path with lane markings (Sharrows) establishing a bicycle thoroughfare from the upper part of the park to Duquesne Avenue; 5) complete the bicycle and pedestrian connection to the Ballona Creek Bike Path at Duquesne Avenue entrance; 6) install the appropriate wayfinding, warning, regulatory and object markers consistent with the Park to Play plan guidelines.

The Baldwin Hills Conservancy (BHC) granted \$336,143 in Proposition 84 funds to the City of Culver City for the completion of this project through BHC Resolution 15-03 on October 23, 2015. Conservancy staff worked closely with City staff to create a grant agreement which was acceptable to both the Conservancy and the City. The grant agreement was executed effective March 1, 2016.

The project planning and design began in spring of 2016. During this phase the project encountered several delays while completing the construction design documents.

- 1) A preliminary geotechnical soils analysis of the slope between the Upper Ball Fields and the Lower Ball Field (*See Figure 2, Attachment 2*) raised concern about constructing the concrete ADA ramp. The city engineer and the project's design consultant thoroughly analyzed the issue before determining that plans were satisfactory, as the excavation required would be minimal and would not compromise the slope.
- 2) The original design for the path from the Nature Trail Boardwalk to Duquesne Avenue posed several challenges including: lack of space on the entrance shoulder to accommodate the ADA path; conflict with access to the park maintenance yard; loss of multiple parking stalls; and an impractical route which could discourage use. An improved design for this part of the path (*See Figure 3, Attachment 2*) created an ADA ramp and a new crosswalk.
- 3) A final review of the Wayfinding Plans developed by Mountains Recreation and Conservation Authority (MRCA) required several revisions to ensure proper integration with the project design plans.

The above factors set the project timeline back significantly. However, as explained in an Extension Request Letter from Culver City Director of Public Works, Charles Herbertson (*See Attachment 3.*) This will result in a better overall experience for future users of the Park to Playa Trail. As of this week, the construction bid for the project has been advertised by the City of Culver City. Bid opening is scheduled for May 4, 2017. The revised project timeline (*See Attachment 4*) accounts for these delays, and forecasts project completion by summer 2018.

BALDWIN HILLS CONSERVANCY (BHC)

RESOLUTION 16-09

RESOLUTION AUTHORIZING THE EXECUTIVE OFFICER TO AMEND THE PROJECT SCOPE, TIMELINE AND BUDGET IN AN AMOUNT NOT TO EXCEED \$80,000 FOR GRANT AGREEMENT #BHC15002 WITH CULVER CITY FOR THE PARK TO PLAYA TRAIL BALLONA CREEK CONNECTION

WHEREAS, under Division 22.7 of the California Public Resources Code, the Baldwin Hills Conservancy was created to acquire open space and manage public lands within the Baldwin Hills area and to provide recreation, restoration and protection of wildlife habitat within the Conservancy territory; and

WHEREAS, Public Resources Code 32569 (a) states the Conservancy may award grants to local public agencies for the purposes of its division; and

WHEREAS, pursuant to Public Resources Code 75060, funds from the Safe Drinking Water, Water Quality and Supply, Flood Control, River and Coastal Protection Bond Act of 2006 are available for projects in the Baldwin Hills and Ballona Creek Watershed to promote access to and enjoyment of the coastal resources of the State; and

WHEREAS, the BHC Governing Board adopted Resolution 15-03, awarding Culver City \$336,143 in BHC Prop 84 funds for the Park to Playa Trail Ballona Creek Connection; and

WHEREAS, Culver City has requested a twelve (12) month performance period extension due to unforeseen delays in contracting, bidding and trail design; and

WHEREAS, Culver City has upgraded the trail design at an anticipated budget increase of 20% to include additional engineering and materials as well as improved ADA access from the lower landing to Duquesne Ave; and

WHEREAS, under Public Resources Code 15333 this action is exempt from the environmental impact requirements of the California Environmental Quality Act (CEQA); now

THEREFORE BE IT RESOLVED, THE BHC GOVERNING BOARD:

1. AUTHORIZES THE EXECUTIVE OFFICER TO AMEND THE PROJECT SCOPE AND EXTEND THE PERFORMANCE PERIOD BY TWELVE (12) MONTHS THROUGH JUNE 30, 2018
2. AUTHORIZES A BUDGET INCREASE IN AN AMOUNT NOT TO EXCEED \$80,000 IN BHC PROP 84 GRANT FUNDS
3. - ADOPTS THE RECOMMENDATIONS DATED APRIL 28, 2017 FOR THIS ITEM
4. - APPOINTS THE EXECUTIVE OFFICER, AS AGENT TO CONDUCT ALL NEGOTIATIONS, EXECUTE AND SUBMIT ALL DOCUMENTS INCLUDING, BUT NOT LIMITED TO AGREEMENTS, PAYMENT REQUESTS, AND CERTIFICATIONS WHICH MAY BE NECESSARY FOR THE COMPLETION OF THE AFOREMENTIONED PROJECT(S)

Passed and Adopted by the Board of the
BALDWIN HILLS CONSERVANCY

On _____, 2017.

Dr. Yolanda Gorman, Chair

ATTEST: _____
David Edsall, Deputy Attorney General
State of CA, Department of Justice

**I. SUMMARY LEVEL SCOPE AND FUNDING DETAILS FOR CULVER CITY/PARK TO PLAYA –
BALLONA CREEK CONNECTION PROJECT**

Updated 4-20-17

| <u>Item No.</u> | <u>Summary Description</u> | <u>Funded by BHC</u> | <u>Funded by CC</u> | <u>TOTAL</u> |
|--|------------------------------------|-----------------------------|----------------------------|---------------------|
| A. ADMINISTRATION | | | | |
| 1. | (Design/Mgmt) - | \$18,765 | \$24,070 | |
| | Subtotal | \$48,765 | \$24,070 | \$72,835 |
| B. CONSTRUCTION (Upper ADA Paths) | | | | |
| B.1a | Construction (M/D/Field Sup.) | \$24,940 | \$0 | |
| B.1b | Construction (Grading/Erosion) | \$66,581 | \$2,691 | |
| B.1c | Construction (ADA Concrete Path) | \$0 | \$137,571 | |
| B.1d | Construction (DG/Pedestrian Paths) | \$68,144 | \$0 | |
| B.1e | Construction (Wayfinding signage) | \$13,050 | \$0 | |
| | Subtotal | \$172,715 | \$140,262 | \$312,977 |
| C. CONSTRUCTION (Lower ADA Paths) | | | | |
| C.2a | Construction (M/D/Field Sup.) | \$27,270 | \$0 | |
| C.2b | Construction (Grading/Erosion) | \$30,546 | \$0 | |
| C.2c | Construction (DG/Timber Paths) | \$45,379 | \$0 | |
| C.2d | Construction (ADA Concrete Path) | \$53,195 | \$0 | |
| C.2e | Construction (Pedestrian Path) | \$17,200 | \$0 | |
| C.2f | Construction (Wayfinding signage) | \$14,500 | \$0 | |
| C.2g | Construction (CCPW Bicycle Path) | \$0 | \$0 | |
| | Subtotal | \$188,090 | \$0 | \$188,090 |
| D. ADMINISTRATION | | | | |
| 1. | (Project Close-out) | \$0 | \$11,700 | |
| | Subtotal | \$0 - | \$1,700 | \$11,700 |
| PROJECT TOTAL WITHOUT CONTINGENCY | | | | \$585,602 |

| <u>Item No.</u> | <u>Summary Description</u> | <u>Funded by BHC</u> | <u>Funded by CC</u> | <u>PROJECT TOTAL</u> |
|------------------------|-----------------------------------|-----------------------------|----------------------------|-----------------------------|
| - | Owner Contingency | \$6,473 | \$3,749 | \$10,222 |
| A & D | Administration Totals | \$48,765 | \$35,770 | \$84,535 |
| B & C | Construction Totals | \$360,805 | \$140,262 | \$501,067 |
| | Overall Project Totals | \$416,043 | \$179,781 | \$595,824 |

Park 2 Playa Trail in Culver City Park

Upper ADA Ramp Switchbacks

Boardwalk Nature Trail

Lower Parking Lot

Upper Ball Fields

Lower Ball Field

Jefferson Blvd

Leash Ln

Supreme Ave

North Arrow

[illegible]

Figure 2: ADA Switchback Ramp from Upper to Lower Ballfields

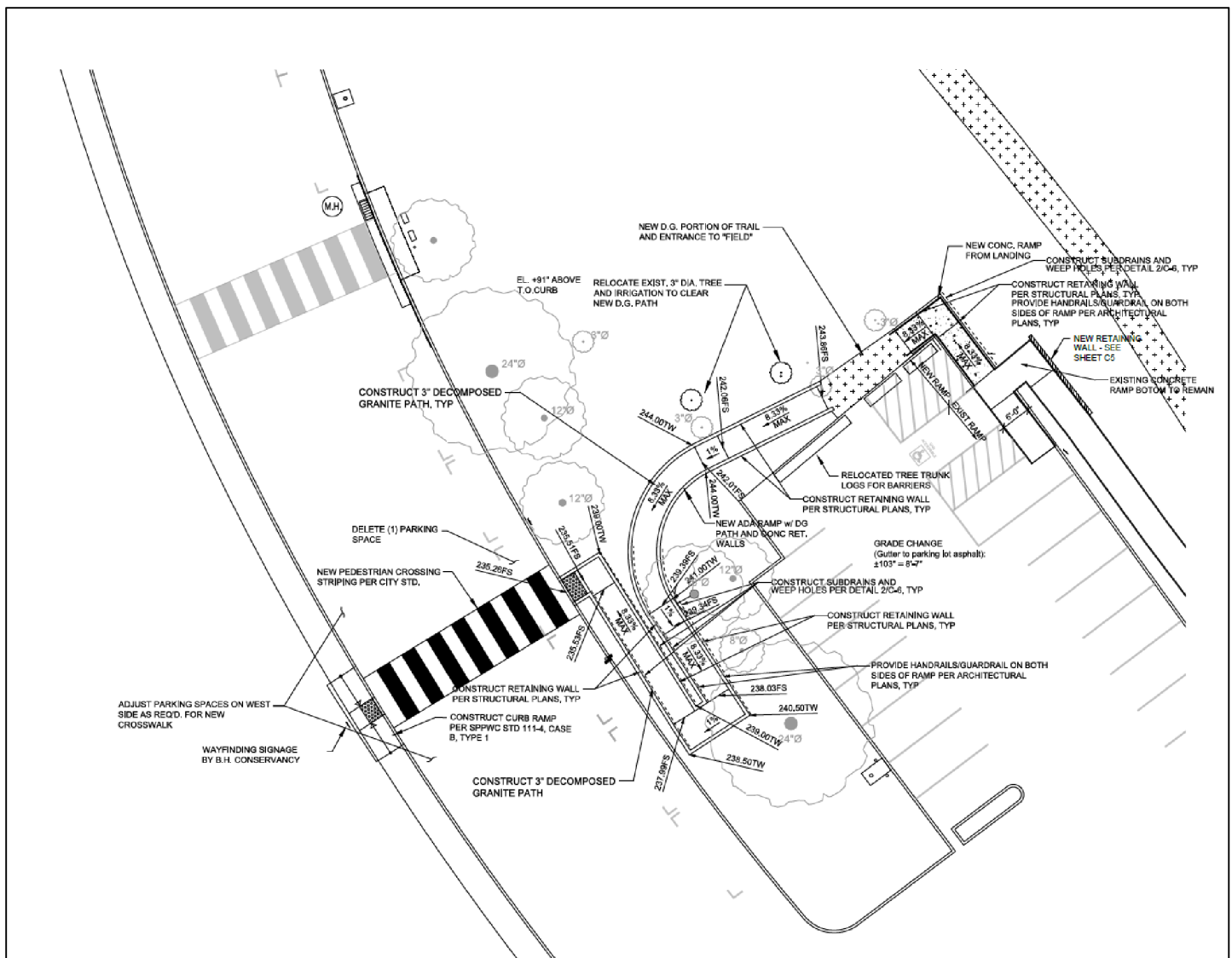
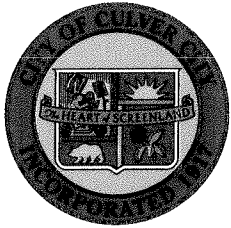
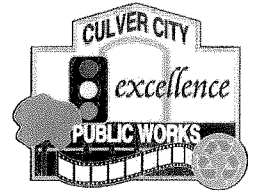

Figure 3: Lower Parking Lot ADA Ramp and Crossing



Culver CITY
PUBLIC WORKS DEPARTMENT
9770 Culver Boulevard, Culver City, California 90232



Charles D. Herbertson
Public Works Director/City
Engineer

(310) 253-5600
FAX (310) 253-5626

April 13, 2017

David F. McNeill, Executive Officer
Baldwin Hills Conservancy
5120 West Goldleaf Circle, Suite 290
Los Angeles, CA 90056

SUBJECT: REQUEST FOR AN AMENDMENT TO PROPOSITION 84 GRANT
AGREEMENT NUMBER BHC 15002

Dear Mr. McNeill:

I am writing on behalf of the City of Culver City (the "City") to request an amendment to Proposition 84 Grant Agreement Number BHC 15002 (the "Grant") for the Culver City / Park to Playa – Ballona Creek Connection Project (the "Project") to extend the Performance Period and revise the Project Budget. These adjustments to the original Agreement are being requested due to a combination of the following factors: (1) prolonged discussions and Grant Agreement negotiations after the Project was approved; (2) delays stemming from the geotechnical analysis of the site of the Americans with Disabilities Act (ADA) compliant ramp that will provide access from the Upper Ball Fields to the Lower Ball Field within Culver City Park; (3) agreed upon trail route changes for the new ADA accessible path from the lower landing of the Nature Trail Boardwalk to the existing sidewalk adjacent to the lower parking lot; and, (4) updates to, and the incorporation into the Project design of, the Wayfinding Plan developed by the Mountains Recreation and Conservation Authority (MRCA) for Park to Playa Regional Trail Segment 7 which resulted in the postponement of the publication of the Notice Inviting Bids for the Project.

The City of Culver City was first informed in November 2015 that the application to the Baldwin Hills Conservancy Prop 84 grant program for the Project had been accepted. This initial notification was followed by extended discussions over the next several months regarding adjustments to the required Grant documents and to the language and specifications of certain sections of the Grant Agreement. The final Agreement was sent to the City for signature in April 2016. The fully-executed Grant Agreement was received by the City in early May 2016. Although some design work for the Project, including research and the preparation of documents, began in March 2016, the six-month interval

between acceptance of the project and receipt of the fully-executed Grant Agreement put the Project behind schedule.

The geotechnical analysis of the site of the Americans with Disabilities Act (ADA) compliant ramp that will provide access from the Upper Ball Fields to the Lower Ball Field within Culver City Park yielded results that raised concerns for the geotechnical engineer. Shifting of the soil can and does occur due to the fact that certain areas of Culver City Park are located atop a landfill that existed in the area and was closed in 1960. The uncertainty inherent in these conditions caused the geotechnical engineer to decline to sign-off on the plans for the ADA compliant ramp. This caused delays to the project since multiple individual and Project team discussions had to be held to determine the best way to move forward with the Project. Acting in my role as City Engineer, I determined that the plans for the ADA compliant ramp were satisfactory and that the Project should move to the next phase since the grading and excavation at that site will be minimal and plan approval by the geotechnical engineer is not necessarily required. As you may recall, this information was conveyed to you during our August 2, 2016 meeting at City Hall in Culver City.

A preliminary Project site inspection attended by City staff, the City's design consultant and representatives of the Baldwin Hills Conservancy was performed at Culver City Park on September 6, 2016. As a result of this inspection, all parties agreed that the original design of the ADA accessible path from the lower Nature Trail Boardwalk landing through the lower parking lot to the sidewalk was not practical nor did it meet the accessibility goals of the Project. Instead, a different trail route was devised to create this connection that will include a new ADA compliant concrete pathway and ramp and a new crosswalk. To accomplish this new, improved route, existing plans had to be revised resulting in unanticipated design costs and associated delays. In addition, the Project Budget must be increased to cover the cost of these improvements.

On January 23, 2017, the City Council of the City of Culver City approved the final plans and specifications and authorized the publication of a Notice Inviting Bids for the Culver City / Park to Playa – Ballona Creek Connection Project. A final review of the Project revealed that the Wayfinding Plan developed by the Mountains Recreation and Conservation Authority (MRCA) for Park to Playa Regional Trail Segment 7 (through Culver City Park) had not been updated in several years and/or adequately incorporated into the Project design. During recent meetings held to rectify this situation, the MRCA agreed to update the Wayfinding Plan and to manufacture and deliver the necessary signage. Although we consider this to be another positive development in the progression of the Project, the Wayfinding Plan efforts necessitated the postponement of the publication of a Notice Inviting Bids until April 2017.

In closing, I want to affirm that the City of Culver City is fully committed to the development and implementation of the Culver City / Park to Playa – Ballona Creek Connection Project. In fact, in addition to the required matching funds for the Project, the City has agreed to commit between \$200,000 and \$400,000 (depending upon the availability of grant funding) for the refurbishment of the Nature Trail Boardwalk. The Boardwalk lies at the heart of Park to Playa Segment 7 and will be improved concurrently

with the construction of the new ADA compliant route that connects the Baldwin Hills Scenic Overlook with Ballona Creek.

If you have any questions regarding the information contained within this request, please contact the Culver City / Park to Playa – Ballona Creek Connection Project Manager, Mate Gaspar, Engineering Services Manager at (310) 253-5602 or Mate.Gaspar@CulverCity.org. You may also contact Patrick Reynolds, Parks Manager / City Landscape Architect at (310) 253-6471 or Patrick.Reynolds@CulverCity.org.

Sincerely,

A handwritten signature in black ink, appearing to read 'C. Herbertson', with a large loop at the start and a horizontal line extending to the right.

Charles D. Herbertson, P.E., L.S.
Public Works Director / City Engineer
City of Culver City
9770 Culver Blvd.
Culver City, CA 90232

cc: John Nachbar, City Manager, City of Culver City
Daniel Hernandez, M.P.A., Director of Parks, Recreation & Community Services

Park to Playa Trail - Ballona Creek Connection
REVISED PROJECT TIMELINE

| No | OBJECTIVE | TASK / SUB-TASK | Original Start Date | Original End Date | New Start Date | New End Date |
|-----------|--|---|---------------------|-------------------|----------------|--------------|
| A. | Administration: Design & Project Management | | | | | |
| 1 | Project Management | 1(a) Complete CEQA; work with Design Team to prepare Design documents. | 3/1/2016 | 4/22/2016 | Same | 12/30/16 |
| | | 1(b) Work with City Clerk's Office & Finance to prepare bid documents; request to go out to bid; open bid period. | 4/1/2016 | 5/31/2016 | 4/1/2017 | 5/31/2017 |
| | | 1(c) Close bid period; review bids; select contractor; seek City Council approval to award contract; work with City Attorney's Office to prepare contract; sign contract; begin work. | 6/1/2016 | 7/11/2016 | 5/1/2017 | 6/30/2017 |
| | | 1(d) Project oversight and coordination; inspections & permitting, as necessary. | 7/11/2016 | 11/23/2016 | 7/1/2017 | 11/23/2017 |
| 2 | All Project Sites / Geotechnical Soils Analysis | Perform geotechnical soils analysis; generate reports and submit them to City Staff and Design Team. | 3/1/2016 | 4/22/2016 | 6/1/2016 | 12/30/2016 |
| 3 | New ADA Path / Architectural Design | Research & prepare Architectural site plans, evaluations & sections, including final construction documents. | 3/1/2016 | 4/22/2016 | 6/1/2016 | 12/30/2016 |
| 4 | New ADA Path / Structural Design | Research & prepare updated Structural plans, evaluations & details, including final construction documents. | 3/1/2016 | 4/22/2016 | 6/1/2016 | 12/30/2016 |
| 5 | New ADA Path / Civil Design | Research & prepare updated Civil plans & details for retaining walls and graded walkways, including final construction documents. | 3/1/2016 | 4/22/2016 | 6/1/2016 | 12/30/2016 |
| 6 | Improve Existing Culver City Park Trail | Research & prepare Architectural site plans, evaluations & sections, including final construction documents. | 3/1/2016 | 4/22/2016 | 6/1/2016 | 12/30/2016 |

| | | | | | | |
|--|---|--|-----------------|-------------------|-----------------|-------------------|
| | / Architectural Design | | | | | |
| 7 | Improve Existing Culver City Park Trail / Structural Design | Research & prepare updated Structural plans, evaluations & details, including final construction documents. | 3/1/2016 | 4/22/2016 | 6/1/2016 | 12/30/2016 |
| 8 | Improve Existing Culver City Park Trail / Civil Design | Research & prepare updated Civil plans & details for retaining walls and graded walkways, including construction final documents. | 3/1/2016 | 4/22/2016 | 6/1/2016 | 12/30/2016 |
| A. Administration Timeline Summary: Design & Project Management | | | 3/1/2016 | 11/23/2016 | 3/1/2016 | 12/30/2016 |
| B. | Construction: Construct New ADA Path | | | | | |
| 1 | Mobilization | Set up temporary railings & barricades prior to & during work progress. Move protection as the work progresses. | 7/11/2016 | 11/23/2016 | 7/1/2017 | 11/30/2017 |
| 2 | Demolition | Dumpsters, 40 yd. & low boy. | 7/11/2016 | 7/19/2016 | 7/1/2017 | 11/30/2017 |
| 3 | Field Supervision | General supervision (Field) - 150 hrs. x \$95/hr. | 7/11/2016 | 11/23/2016 | 7/1/2017 | 11/30/2017 |
| 4 | Remove Existing Irrigation | Remove existing spray heads & irrigation piping. | 7/11/2016 | 7/19/2016 | 7/1/2017 | 11/30/2017 |
| 5 | Grading & Erosion Control | Trim shrubs, reshape hillside to accommodate new ADA ramp with switchbacks up to Little League field. | 7/19/2016 | 8/8/2016 | 7/1/2017 | 11/30/2017 |
| 6 | Grading & Erosion Control | Place sandbags along roadway for erosion control. | 8/12/2016 | 8/18/2016 | 7/1/2017 | 11/30/2017 |
| 7 | Grading & Erosion Control | SECTION 7.1: Grade existing dirt and remove Natural, but not Fabricated, Barriers to create even and smooth surfaces along existing designated P2P Trail Section 7.1, originating at the Baldwin Hills Overlook gate, running along the eastern boundary of Little League Field fence, and connecting to the top of the new ADA ramp in Section 7.2a. | 8/12/2016 | 8/26/2016 | 7/1/2017 | 11/30/2017 |

| | | | | | | |
|----|---|---|------------|------------|----------|------------|
| 8 | Grading & Erosion Control | Place 5/16" wood edging along both sides of new ADA pathways (use existing edging where already in place). | 8/29/2016 | 9/2/2016 | 7/1/2017 | 11/30/2017 |
| 9 | Grading & Erosion Control | SECTION 7.2a: Trim tree roots, grade existing dirt and remove Natural, but not Fabricated, Barriers to create even and smooth surfaces from new ADA curb cut at roadway along the north facing hilltop , past the sundial and over to the Existing Trail entry. | 9/5/2016 | 9/9/2016 | 7/1/2017 | 11/30/2017 |
| 10 | Grading & Erosion Control | Place 5/16" wood edging along both sides of new ADA pathway. | 9/12/2016 | 9/16/2016 | 7/1/2017 | 11/30/2017 |
| 11 | Concrete/Rebar ADA Path & Retaining Wall Construction | Site survey and field verification. | 9/12/2016 | 9/16/2016 | 7/1/2017 | 11/30/2017 |
| 12 | Concrete/Rebar ADA Path & Retaining Wall Construction | Excavate for footings each side of ramp. | 9/19/2016 | 9/22/2016 | 7/1/2017 | 11/30/2017 |
| 13 | Concrete/Rebar ADA Path & Retaining Wall Construction | Place gravel and drainage piping to facilitate water dispersion. | 9/22/2016 | 9/28/2016 | 7/1/2017 | 11/30/2017 |
| 14 | Concrete/Rebar ADA Path & Retaining Wall Construction | Place formwork and set reinforcing steel for footings. | 9/29/2016 | 10/6/2016 | 7/1/2017 | 11/30/2017 |
| 15 | Concrete/Rebar ADA Path & Retaining Wall Construction | Pour concrete. | 10/6/2016 | 10/11/2016 | 7/1/2017 | 11/30/2017 |
| 16 | Concrete/Rebar ADA Path & Retaining Wall Construction | Strip forms, replace dirt behind retaining wall, slope to downhill directions (varies based upon switchback). | 10/11/2016 | 10/17/2016 | 7/1/2017 | 11/30/2017 |
| 17 | Concrete/Rebar ADA Path & Retaining Wall Construction | Compact and grade ADA pathway (4 switchbacks). | 10/17/2016 | 10/20/2016 | 7/1/2017 | 11/30/2017 |

| | | | | | | |
|---|---|--|------------------|-------------------|-----------------|-------------------|
| 18 | Concrete/Rebar ADA Path & Retaining Wall Construction | Place gravel under slab sections. | 10/20/2016 | 10/22/2016 | 7/1/2017 | 11/30/2017 |
| 19 | Concrete/Rebar ADA Path & Retaining Wall Construction | Place formwork for curbs and set reinforcing steel for curbs and slabs. | 10/22/2016 | 10/28/2016 | 7/1/2017 | 11/30/2017 |
| 20 | Concrete/Rebar ADA Path & Retaining Wall Construction | Pour concrete. | 10/28/2016 | 11/2/2016 | 7/1/2017 | 11/30/2017 |
| 21 | Concrete/Rebar ADA Path & Retaining Wall Construction | Place debris in recycling bins. | 10/28/2016 | 11/2/2016 | 7/1/2017 | 11/30/2017 |
| 22 | Connect New ADA Path to Existing Trails | Excavate, remove existing curb, form and pour new ADA curb cut and transitional skid proof surfaces. | 11/2/2016 | 11/9/2016 | 7/1/2017 | 11/30/2017 |
| 23 | Connect New ADA Path to Existing Trails | Layout and paint ADA warning and pathway striping across lower road. | 11/10/2016 | 11/15/2016 | 7/1/2017 | 11/30/2017 |
| 24 | Connect New ADA Path to Existing Trails | Prepare submittals, fabricate signage, install signage along ADA pathway from Baldwin Hills Overlook entry to Existing Trail within Culver City Park ("Existing CCP Trail"). | 11/16/2016 | 11/23/2016 | 7/1/2017 | 11/30/2017 |
| 25 | Connect New ADA Path to Existing Trails | Deliver, spread and then compact decomposed granite at ADA pathway. | 11/16/2016 | 11/23/2016 | 7/1/2017 | 11/30/2017 |
| B. Construction Timeline Summary: Construct New ADA Path | | | 7/11/2016 | 11/23/2016 | 7/1/2017 | 11/30/2017 |
| C. | Construction: Improve Existing CCP Trail/Complete Ballona Creek Connection | | | | | |
| 1 | Mobilization | Set up temporary railings & barricades prior to & during work progress. Move protection as the work progresses. | 7/11/2016 | 11/23/2016 | 12/1/2017 | 4/30/2018 |
| 2 | Demolition | Dumpsters, 40 yd. & low boy. | 7/11/2016 | 7/19/2016 | 12/1/2017 | 4/30/2018 |
| 3 | Field Supervision | General supervision (Field) - 220 hrs. x \$95/hr. | 7/11/2016 | 11/23/2016 | 12/1/2017 | 4/30/2018 |

| | | | | | | |
|----|---|--|-----------|-----------|-----------|-----------|
| 4 | Erosion Control & Retaining Wall Construction | Trim shrubs, reshape hillside to remove dirt/shrubs from contact with the walkway. Collect debris for recycling. | 7/11/2016 | 7/19/2016 | 12/1/2017 | 4/30/2018 |
| 5 | Erosion Control & Retaining Wall Construction | Clear dirt to 6" below. | 7/19/2016 | 8/8/2016 | 12/1/2017 | 4/30/2018 |
| 6 | Erosion Control & Retaining Wall Construction | Clean wood support posts and recoat. | 8/12/2016 | 8/18/2016 | 12/1/2017 | 4/30/2018 |
| 7 | Erosion Control & Retaining Wall Construction | Collect site rocks/boulders for use in wall. | 8/12/2016 | 8/26/2016 | 12/1/2017 | 4/30/2018 |
| 8 | Erosion Control & Retaining Wall Construction | Place gravel, mortar bed and drainage piping. | 8/29/2016 | 9/2/2016 | 12/1/2017 | 4/30/2018 |
| 9 | Erosion Control & Retaining Wall Construction | Replace dirt behind retaining wall, slope to downhill away from walkway stringers. | 9/5/2016 | 9/9/2016 | 12/1/2017 | 4/30/2018 |
| 10 | Erosion Control & Retaining Wall Const. | Remove added dirt & debris. | 9/12/2016 | 9/16/2016 | 12/1/2017 | 4/30/2018 |
| 11 | Erosion Control & Retaining Wall Construction | Place gravel and drainage piping. | 9/12/2016 | 9/16/2016 | 12/1/2017 | 4/30/2018 |
| 12 | Erosion Control & Retaining Wall Construction | Place formwork and set reinforcing steel. | 9/19/2016 | 9/22/2016 | 12/1/2017 | 4/30/2018 |
| 13 | Erosion Control & Retaining Wall Construction | Pour concrete. | 9/22/2016 | 9/28/2016 | 12/1/2017 | 4/30/2018 |

| | | | | | | |
|---|---|--|------------------|-------------------|-------------------|------------------|
| 14 | Erosion Control & Retaining Wall Construction | Strip forms, replace dirt behind retaining wall, slope to downhill away from walkway stringers. | 9/29/2016 | 10/6/2016 | 12/1/2017 | 4/30/2018 |
| 15 | Resurface Upper & Lower Landings | Trim shrubs, reshape hillside to remove dirt/shrubs from contact with the walkway. Collect debris for recycling. | 10/6/2016 | 10/11/2016 | 12/1/2017 | 4/30/2018 |
| 16 | Resurface Upper & Lower Landings | Clear dirt on up-slope and down-slope to prepare for new retaining wall. | 10/11/2016 | 10/17/2016 | 12/1/2017 | 4/30/2018 |
| 17 | Resurface Upper & Lower Landings | Place gravel, mortar bed and drainage piping. | 10/17/2016 | 10/20/2016 | 12/1/2017 | 4/30/2018 |
| 18 | Resurface Upper & Lower Landings | Install new wood retaining walls on both slopes. | 10/20/2016 | 10/22/2016 | 12/1/2017 | 4/30/2018 |
| 19 | Resurface Upper & Lower Landings | Replace dirt behind retaining wall, slope to downhill away from walkway stringers. | 10/22/2016 | 10/28/2016 | 12/1/2017 | 4/30/2018 |
| 20 | Resurface Upper & Lower Landings | Grade to 6" below finish surface. | 10/28/2016 | 11/2/2016 | 12/1/2017 | 4/30/2018 |
| 21 | Resurface Upper & Lower Landings | Place gravel and mesh on new walkway. | 10/28/2016 | 11/2/2016 | 12/1/2017 | 4/30/2018 |
| 22 | Resurface Upper & Lower Landings | Pour concrete. | 11/2/2016 | 11/9/2016 | 12/1/2017 | 4/30/2018 |
| 23 | Resurface Upper & Lower Landings | Remove debris from site. | 11/10/16 | 11/15/16 | 12/1/2017 | 4/30/2018 |
| 24 | Extend Existing CCP Trail | Construct DG trail to connect existing CCP Trail to Duquesne Avenue. | 11/16/16 | 11/23/16 | 12/1/2017 | 4/30/2018 |
| 25 | Extend Existing Bike Path | Designate Bicycle Path from CC Gateway to Ballona Creek Bike Path - Install striping & signage. | 11/16/16 | 11/23/16 | 12/1/2017 | 4/30/2018 |
| C. Construction Timeline Summary: Improve Existing CCP Trail/Complete Ballona Creek Connection | | | 7/11/2016 | 11/23/2016 | 12/01/2017 | 4/30/2018 |

| | | | | | | |
|--|---|--|--------------------------|-------------------------|------------------------|-------------------------|
| D. | Administration: Project Closeout | | | | | |
| 1 | Inspect Project for Compliance & Completion | Final site visits by City Staff & Contractor; punch list developed. Punch list items completed by Contractor. Final Project Review and Inspection. | 11/28/2016 | 12/30/2016 | 5/1/2018 | 6/30/2018 |
| 2 | Administrative Closeout | Notice of Completion prepared; documents prepared for City Council acceptance of work. City Council accepts work. | 1/3/2017 | 1/23/2017 | 5/1/2018 | 6/30/2018 |
| 3 | Release of Final Payment | Notice of Completion filed. Final payment is released to Contractor. | 1/24/2017 | 2/27/2017 | 5/1/2018 | 6/30/2018 |
| 4 | Grant Closeout | Grant closeout documents are prepared; staff waits for the final payment to the Contractor to be processed by the Finance Department so that the final Payment Request can be submitted. | 2/28/2017 | 3/31/2017 | 5/1/2018 | 6/30/2018 |
| <i>D. Administration Timeline Summary: Project Closeout</i> | | | <i>11/28/2016</i> | <i>3/31/2017</i> | <i>5/1/2018</i> | <i>6/30/2018</i> |

BALDWIN HILLS CONSERVANCY

5120 West Goldleaf Circle, Suite 290
Los Angeles, CA 90056
(323) 290-5270 Phone
www.bhc.ca.gov

Memorandum

To: Governing Board

From: David McNeill, Executive Officer

Date: April 28, 2017

Re: Item 4: Executive Officer Report

Projects Status Report

Please see Attachment #1 for the updated Baldwin Hills Conservancy (BHC) Local Assistance/Capital Outlay Projects Status Report.

Fiscal Update

Please see Attachment #2; BHC Summary Expenditure Sheet by Fund, and Attachment #3; BHC Prop 40 & Prop 84 Bond Cash Funds. The reports correspond with the end of month eight (8) for the 2016-17 Fiscal Year.

Community Outreach and Events

On April 8th, the Conservancy partnered with L.A. County to celebrate the opening of the Stoneview Nature Center in Blair Hills. Chairman Gorman participated in the event hosted by Supervisor Mark Ridley-Thomas along with several key elected official guests including Assemblyman Sebastian Ridley-Thomas, Culver City Mayor Jim Clark, and Retired Senator Kevin Murray. The event was well attended with residents, nature enthusiasts, boy scouts and families all joining the range of activities from salsa dancing, cooking and art, to exploring wildlife featured on the five-acre site.

Staff developed a Baldwin Hills Conservancy information and interpretive display booth for use at the following community events:

April 15 - Social Justice Learning Institute "Renew the Cool" Earth Day – Inglewood
April 20 - Sony Earth Day – Culver City
April 22 – Los Angeles SAN Earth Day – Exposition Park

BHC Project Status Report

| Grantee | Project Title | Contract ID | Fund Source | Funds Allocated | Agreement Expiration | PROJECT STATUS |
|--|--------------------------------------|-------------|-------------|-----------------|----------------------|--|
| Los Angeles County Dept. of Parks and Recreation | Stoneview Nature Center | BHC12002 | Prop 40 | \$5,000,000 | 6/30/2017 | Grand Opening Event was on Saturday April 8, 2017. Well-attended; activities included: Origami plant boxes for native plant adoption, Salsa dancing, gentle yoga, Creature Connections (animals & insects), salsa & guacamole-making, mindfulness meditation and BHC Staff led Garden tours using the new Stoneview Interpretative APP; Nature Center is open daily 9am-5pm. |
| University of Southern California (USC) | Baldwin Hills Biota Update | BHC13002 | Prop 84 | \$140,794 | 9/31/16 | This project is now complete. The Baldwin Hills Nature website, as well as the Biota Study Update Report are available at www.BaldwinHillsNature.BHC.ca.gov |
| Culver City | Hetzler Road Pedestrian Path at BHSO | BHC16004 | Prop 84 | \$876,477 | 12/31/2017 | Construction underway as of December 2016; Several adjustments have been made to the project including the cable rail design, reinforcement of saturated soils, and accommodations for utility infrastructure; Project completion is expected May 2017. |
| Loyola Marymount University (LMU) | Parklands User Survey Study | BHC14000 | Prop 84 | \$236,042 | 9/31/17 | Fourth and final season of visitor use surveys will be completed in Spring of 2017; Next stage will be the compilation of the project report; Project completion expected Fall 2017. |

BHC Project Status Report

| | | | | | | |
|------------------------------------|---|----------|---------|-----------|-----------|---|
| Culver City | Park to Playa Trail - Ballona Creek Connection | BHC15002 | Prop 84 | \$336,043 | 6/30/2017 | The construction contract is out to bid with bid opening scheduled for May 4, 2017; Changes to the design of several project elements have necessitated an extension to the project timeline; Completion expected Summer 2018. |
| Los Angeles Audubon Society (LAAS) | Baldwin Hills Parklands Conservation Project | BHC15004 | Prop 84 | \$124,536 | 8/31/2019 | The Spring Conservation Camp was held April 10-13, 2017 serving 20 local children aged 8-12; The Spring Semester College Certificate Program is in session. |
| Culver City | Waste Transfer Station Stormwater Diversion and Rain Garden Project | BHC16001 | Prop 1 | \$606,000 | 3/31/2018 | Bid opening for construction of Diversion System scheduled late April; Rain Garden design began in March; Design Consultant currently conducting utility research; conceptual plans expected by May; Project Completion expected Spring 2018. |

BHC Project Status Report

| | | | | | | |
|---|--------------------------------|----------|--------|-----------|-----------|--|
| Mountains Recreation and Conservation Authority (MRCA) | Milton Green Street Project | BHC16002 | Prop 1 | \$745,000 | 8/31/2018 | 1st Notice to Proceed (NTP) has been issued to Contractor for permitting/traffic plan; draft expected late April; Info flyers sent to parents/ community end April; then discussed w/schools & reviewed by City of L.A.; Issuance of 2nd NTP for construction scheduled next quarter; water quality monitor contractor will implement Monitoring and Reporting Plan (MRP) for stormwater associated w/ VSCEs; Project completion expected Summer 2018. |
|---|--------------------------------|----------|--------|-----------|-----------|--|

Baldwin Hills
2016/17 Summary Sheet by Fund

| <u>As of 2/28/2017</u> | <u>PCA #</u> | <u>Original</u> <u>Appropriation</u> | <u>Remaining</u> <u>Appropriation</u> | <u>EXP + ENC</u> | <u>BALANCE</u> | <u>Encumber by</u> | <u>Liquidate by</u> |
|--|--------------|---|--|------------------|------------------|--------------------|---------------------|
| <u>ELPF - #0140, Support</u> | | | | | | | |
| 2016 Budget Act Item 3835-001-0140 | 10001 | \$ 383,000.00 | \$ 383,000.00 | \$ 209,698.26 | \$ 173,301.74 | 06/30/17 | 06/30/19 |
| | | | | | | | |
| <u>Prop 40 - #6029, Support</u> | | | | | | | |
| 2016 Budget Act Item 3835-001-6029 | 10005 | \$ 122,000.00 | \$ 122,000.00 | \$ 69,951.90 | \$ 52,048.10 | 06/30/17 | 06/30/19 |
| | | | | | | | |
| <u>Prop 84 - #6051, Support</u> | | | | | | | |
| 2016 Budget Act Item 3835-001-6051 | 10009 | \$ 129,000.00 | \$ 129,000.00 | \$ 57,889.43 | \$ 71,110.57 | 06/30/17 | 06/30/19 |
| | | | | | | | |
| <u>Prop 1 - #6083, Support</u> | | | | | | | |
| 2016 Budget Act Item 3835-001-6083 | 10006 | \$ 102,000.00 | \$ 102,000.00 | \$ 42,945.01 | \$ 59,054.99 | 06/30/17 | 06/30/19 |
| Total Support Balance: | | | | | \$ 355,515.40 | | |
| | | | | | | | |
| <u>Prop 1 - #6083, Local Assistance/ Capital Outlay</u> | | | | | | | |
| 2016 Budget Act Item 3835-101-6083 | 20006 | \$ 2,000,000.00 | \$ 2,000,000.00 | \$ - | \$ 2,000,000.00 | 06/30/19 | 06/30/21 |
| 2015 Budget Act Item 3835-101-6083 | 20004 | \$ 2,000,000.00 | \$ 2,000,000.00 | \$ - | \$ 2,000,000.00 | 06/30/18 | 06/30/20 |
| Total Prop 1 Balance: | | | | | \$ 4,000,000.00 | | |
| | | | | | | | |
| <u>Prop 40 - #6029, Local Assistance</u> | | | | | | | |
| 2016 Budget Act Item 3835-101-6029 | 20007 | \$ 6,025,000.00 | \$ 6,025,000.00 | \$ - | \$ 6,025,000.00 | 06/30/19 | 06/30/21 |
| | | | | | | | |
| <u>Prop 40 - #6029, Capital Outlay</u> | | | | | | | |
| 2015 Budget Act Item 3835-301-6029 | 20005 | \$ 11,604,000.00 | \$ 9,070,982.80 | \$ 4,082,190.80 | \$ 4,988,792.00 | 06/30/18 | 06/30/20 |
| Total Prop 40 Balance: | | | | | \$ 11,013,792.00 | | |
| | | | | | | | |
| <u>Prop 84 - #6051, Capital Outlay</u> | | | | | | | |
| 2015 Budget Act Item 3835-301-6051 | 30004 | \$ 2,118,000.00 | \$ 2,118,000.00 | \$ 192,490.02 | \$ 1,925,509.98 | 06/30/18 | 06/30/20 |
| 2014 Budget Act Item 3835-301-6051 | 30003 | \$ 3,120,000.00 | \$ 2,212,963.68 | \$ 1,714,056.68 | \$ 498,907.00 | 06/30/17 | 06/30/19 |
| Total Prop 84 Balance: | | | | | \$ 2,424,416.98 | | |

BOND CASH FUNDS
(As of 02/28/17)

| 2015 COMMERCIAL PAPER TE | | CASH ALLOCATED | EXPENDITURES | BALANCE |
|--------------------------|----------|----------------|--------------|--------------|
| | PROP 84: | \$2,077,819.00 | 1,867,790.92 | \$289,670.30 |
| | PROP 40: | \$3,495,784.52 | 3,359,710.18 | \$534,640.74 |
| | PROP 1: | \$122,962.15 | 45,698.67 | \$104,477.26 |

The image displays a 5x4 grid of rectangles. The first column consists of five rectangles of different sizes and internal structures. The other three columns each contain four identical rectangles, each divided into three horizontal sections.